

Section DETAIL A-A

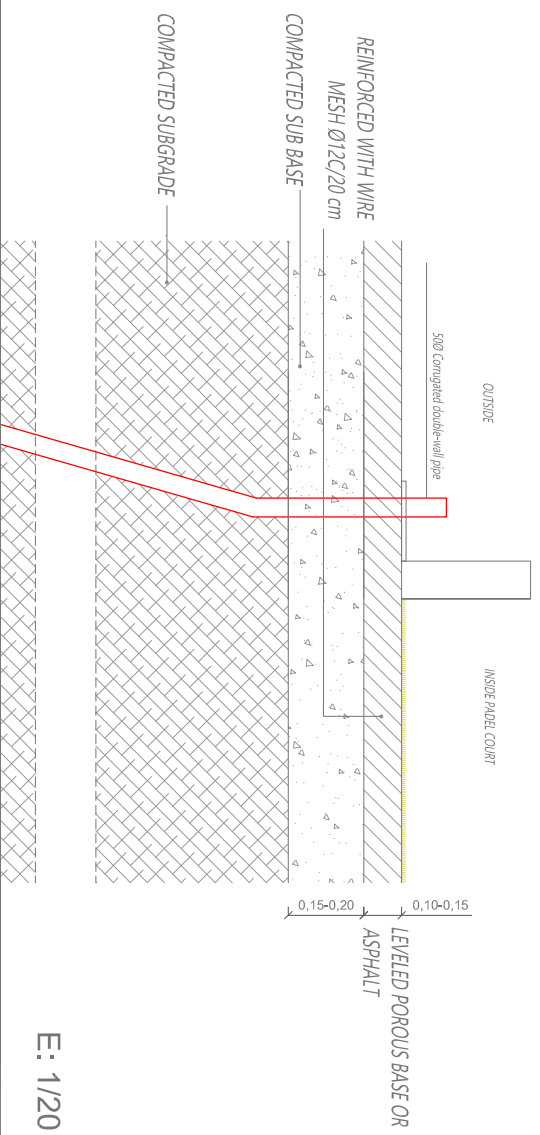

E: 1/20

Cross section DETAIL B-B'

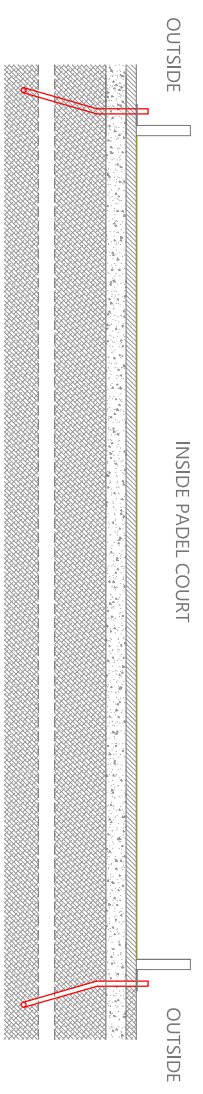

E: 1/75

- NOTE: The artificial turf carpet must be installed on a flat and if possible "rough" surface such as asphalt or unfinished cement. The following installation types must be avoided:**
- Carpet on surface
  - Carpet on NWF (non-woven fabric) substrates
  - Carpet on hard, smooth surfaces such as marble, ceramics, highly compacted cements smoothed with a very fine trowel

E: 1/75 BASE FOR STANDARD PADEL COURT

